



D-RAIL PERFORATED CLADDING SUPPORT RAIL

APPLICATION

The D-Rail is the secondary component of the MFI® system D-Series, designed to attach directly to the THERMABRACKET® and serve as the structural support for cladding. It features an adjustable rail-to-bracket connection that allows up to 3/4 inch of depth adjustability for aligning and plumbing the cladding plane. When fully nested, the D-Rail creates a 1.50 inch air cavity between the cladding and exterior insulation; when fully extended, the air cavity increases to approximately 2.25 inches. This dynamic adjustability makes the D-Rail ideal for accommodating variations in back-up wall construction. The system is suitable for use on vertical wall surfaces and soffits and must be installed over properly spaced THERMABRACKETS, which can be anchored to steel studs (18-gauge min.), wood studs, CMU, or concrete substrates.

D-RAIL PROPERTIES

DEPTH	NET FREE AREA (VENTILATION)	WEIGHT (LBS/FT)	
		18 GA	16 GA
1.50"	14.80%	.50	.63

MATERIAL PROPERTIES & OPTIONS

MATERIAL TYPE		ASTM A1046 ZM40 Steel or 304 Stainless Steel*
DESIGN STEEL THICKNESS	18-GA	0.0484 inches
	16-GA	0.0579 inches
MIN. STEEL THICKNESS	18-GA	0.046 inches
	16-GA	0.055 inches
YIELD STRESS, Fy		50 ksi
AVAILABLE FINISHES		Standard Mill or Black PVDF
STANDARD LENGTH		120 inches Standard (96 inches Available)

Properties are for ZM40 steel products only, contact KWS for stainless steel.

*Asterisk identifies non-standard items - availability & additional cost vary.

All dimensions & weights are nominal.

Black coated components are only coated on one side; opposite side is primed.

Contact KWS to confirm availability - most standard items typically ship within two weeks (quantity dependent).

See system specific guide details for further information on design, detailing and installation.

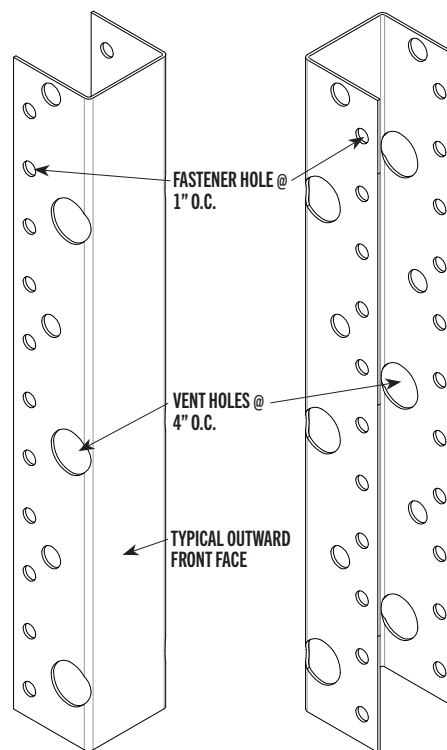

PRODUCT SPECIFICATIONS

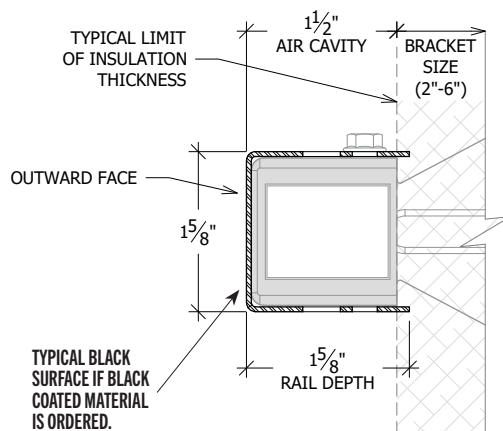

NO EXPRESS WARRANTIES ARE GIVEN EXCEPT FOR ANY APPLICABLE WRITTEN WARRANTIES SPECIFICALLY PROVIDED BY KNIGHT WALL SYSTEMS®. ALL IMPLIED WARRANTIES INCLUDING THOSE OF MERCHANTABILITY AND FITNESS FOR A PARTICULAR PURPOSE ARE EXPRESSLY EXCLUDED. No freedom from any patent owned by KNIGHT WALL SYSTEMS® or others is to be inferred. Because use conditions and applicable laws may differ from one location to another and may change with time, Customer is responsible for determining whether products and the information in this document are appropriate for Customer's use. They are not guaranteed in any way by the Knight Wall Systems, Inc. since building design, engineering, and construction, including workmanship and materials are beyond the control of the manufacturer. The information provided here is subject to change without notice.

All content included on this document is and shall continue to be the property of Knight Wall Systems, Inc. or its content suppliers, and is protected under applicable copyright, trademark, and other proprietary rights. KNIGHT WALL SYSTEMS, the Knight Wall Systems design mark, MFI, THERMABRACKET, THERMASTOP, and FORMED TO PROTECT WHAT MATTERS MOST are trademarks of Knight Wall Systems, Inc. US Patent Nos. 8429866, 8973334, 9677268, 9732518, 98526655, D963894, 11299891, 11286676, and others are registered and pending patents of Knight Wall Systems, Inc. These lists are not exhaustive and Knight Wall Systems, Inc. does not waive its rights in regard to other intellectual property not listed.

© 2025 Knight Wall Systems, Inc. All rights reserved.