



MOVEKLIP™

Design Endlessly.

FORMED TO PROTECT WHAT MATTERS MOST®



Façade designs and panel installation become simpler and more efficient with MOVEKLIP™ by facilitating floor deflection movement within cladding systems while resisting wind load. Its straightforward, installer-friendly design reduces errors and works with PANELRAIL® and various claddings like fiber cement, HPL, and metal panels. Requiring no specialized tools, bolts, or modifications, it simplifies the process and supports virtually unlimited floor movement. With connections that are entirely non-combustible, it ensures reliable fire resistance and safety for every project.

MOVEKLIP™ is designed for vertical framing to cross over floor line deflection joints on a multi-story structure by creating a sliding connection between vertical PANELRAIL® by KWS® and a horizontal subframing layer (such as THERMAZEE®, HCI-Girts or MFI® System). The vertical PANELRAIL® must be attached to the horizontal subframing with a traditional fixed connection on one side of the deflection joint while MOVEKLIP™ is used on the opposite side of the joint. This allows for the floor line movement to occur, while maintaining a static, stable, vertical cladding support system.



Material Properties

MATERIAL TYPE: ASTM A1046 ZM40 Steel

MIN. STEEL THICKNESS: 16 GA | 0.055inches

YIELD STRESS, Fy: 50 KSI

AVAILABLE FINISHES: Standard Mill

SIZE: 2 in. x 2 in.

Contact KWS® for more information on lead times and pricing.

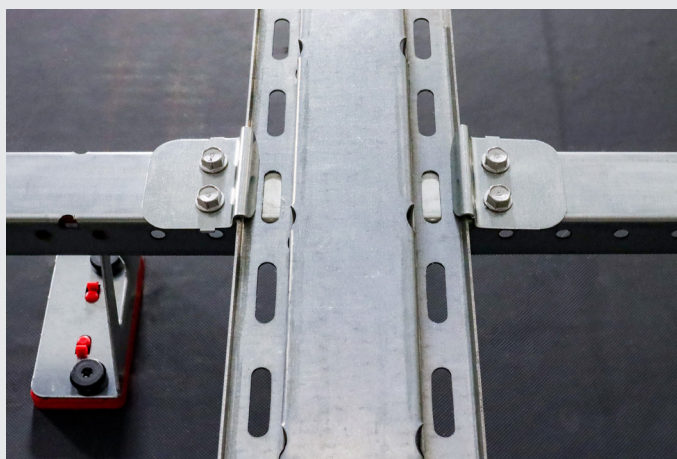

Advantages to MOVEKLIP™

- Eliminates panel joints one floor at a time for seamless design integration.
- Pre-engineered solution facilitates floor deflection in cladding systems.
- No slotted connections reduce the risk of installation errors.
- No overtightened fasteners ensuring proper installation and performance.
- Simple, installer-centered design enhances productivity and reliability.
- Compatible with standard rails and multiple cladding types, including fiber cement, HPL, and metal panels.
- No special bolts, fasteners, polymers, or washers required for installation.
- No special tools, fabrication, or field modifications necessary.
- Allows virtually unlimited floor movement.
- Made of 100% domestic steel with zinc-aluminum-magnesium coating for durability and resiliency.

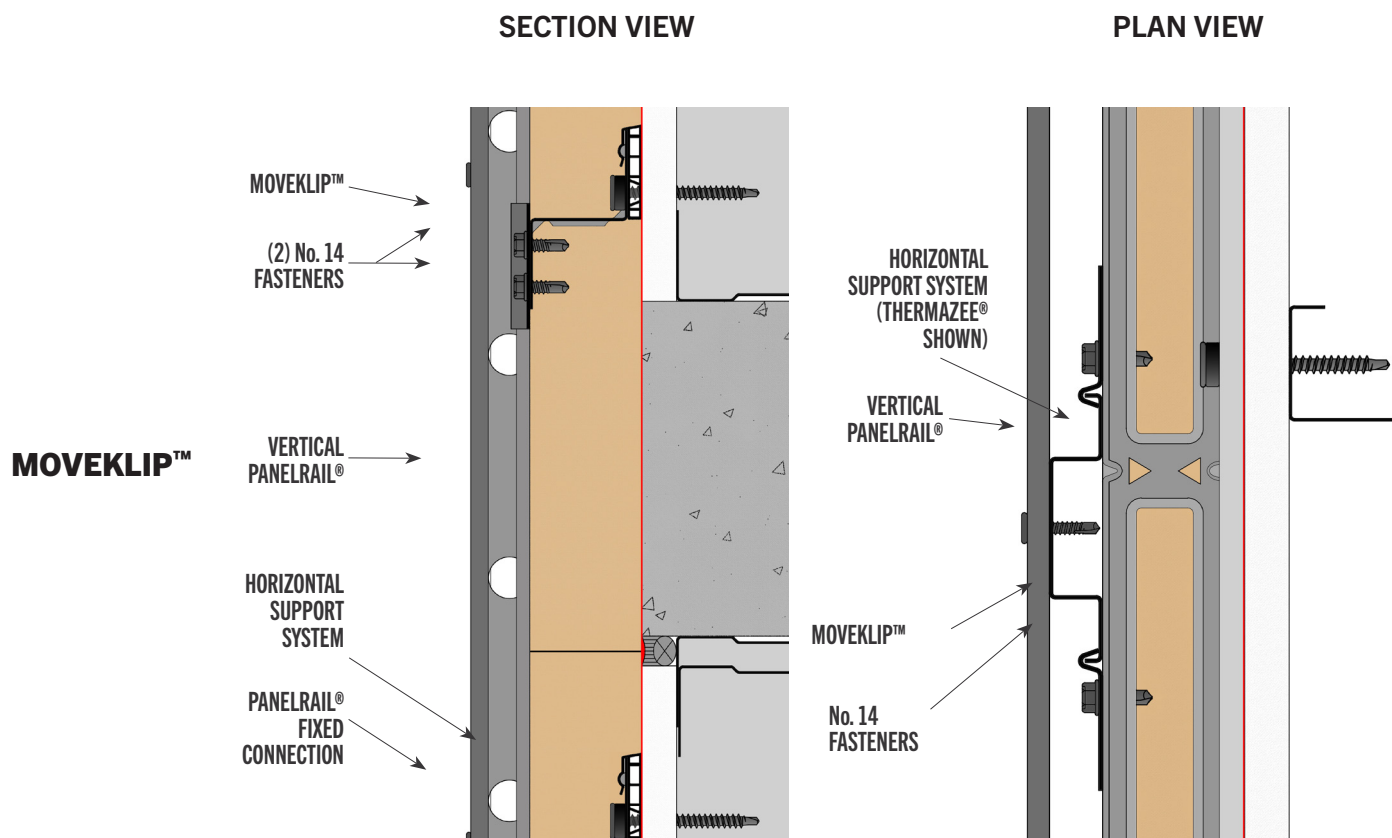

NO EXPRESS WARRANTIES ARE GIVEN EXCEPT FOR ANY APPLICABLE WRITTEN WARRANTIES SPECIFICALLY PROVIDED BY KNIGHT WALL SYSTEMS. ALL IMPLIED WARRANTIES INCLUDING THOSE OF MERCHANTABILITY AND FITNESS FOR A PARTICULAR PURPOSE ARE EXPRESSLY EXCLUDED. No freedom from any patent owned by Knight Wall Systems or others is to be inferred. Because use conditions and applicable laws may differ from one location to another and may change with time, Customer is responsible for determining whether products and the information in this document are appropriate for Customer's use.

All content included on this site is and shall continue to be the property of Knight Wall Systems, Inc. or its content suppliers, and is protected under applicable copyright, trademark, and other proprietary rights. ANKIT, CI, CI-GIRT, KNIGHT WALL SYSTEMS, the Knight Wall Systems design mark, MFI, PANELRAIL, THERMABRACKET, THERMASTOP, THERMAZEE, and FORMED TO PROTECT WHAT MATTERS MOST are trademarks of Knight Wall Systems, Inc. US Patent Nos. 8429866, 8973334, 9677268, 9732518, 98526655, D963894, 11299891, 11286676, and others are registered and pending patents of Knight Wall Systems, Inc. These lists are not exhaustive and Knight Wall Systems, Inc. does not waive its rights in regard to other intellectual property not listed. © 2024 Knight Wall Systems, Inc. All rights reserved.



ALL KNIGHT WALL SYSTEMS
COMPONENTS ARE
MANUFACTURED IN THE USA.

2401 East 6th Street, Deer Park, WA 99006
www.knightwallsystems.com

1-855-597-9255 (KWS-WALL)
509-262-0104